

ITEM	PART NUMBER	DESCRIPTION	QTY	COMMENTS
1	MT207 906 080	MIT SHAFT - SWING	1	
2	MT207 908 580	COVER (v02)	1	Includes items 3, 4 & 5
3	MT572 102 40	GREASE NIPPLE	0	1/8 BSP
4	MT800 118 39	O-RING	0	
5	MT445 821 60	Socket Head Cap Screw	0	M12x30
6	MT207 908 581	COVER (v02)	1	Includes items 3, 4 & 5
7	MT207 939 080	COVER	1	Includes items 3, 8 & 9
8	MT522 450 80	O-RING	0	
9	MT442 500 002	Socket Head Cap Screw	0	M8x25
10	MT207 968 080	SHIM - 0.6mm	1	
11	MT207 969 380	SHIM - 0.6mm	2	
12	MT207 968 081	SHIM - 0.2mm	3	
13	MT264 332 980	FLANGE BEARING	2	
14	MT264 334 480	BUSHING	4	
15	MT264 383 680	COVER	1	Includes items 3, 8 & 16
16	MT442 500 001	Hex Hd Set Screw	0	M6x25 gr10.9
17	MT264 383 684	SHIM - 1.2mm	1	
18	MT264 383 685	SHIM - 0.6mm	2	
19	MT264 397 880	BUSHING	2	
20	MT264 398 0801	FLANGE BEARING	2	
21	MT321 069 080	CROSS PIECE	1	
22	MT323 056 280	MIT SHAFT - VERTICAL	1	
23	MT550 020 150	SWING PIECE	1	
24	MT550 020 460	BODY RH	1	
25	MT873 457 490	SEAL	4	
26	MT879 026 391	SEAL	2	
27	MT670 066 98	Hex Hd Bolt	12	M20x60 gr10.9
28	MT0300 2031	Washer - Hardened	12	M20
29	MT010 146 632	Hex Hd Set Screw	1	M24x65 gr8.8 Jacking bolt
30	MT323 057 580	MIT SHAFT - HORIZONTAL	1	

ITEM	PART NUMBER	DESCRIPTION	QTY	COMMENTS
31	MT264 333 180	FLANGE BEARING	2	
32	MT264 383 681	COVER	1	Includes items 8, 16, 34 & 35
33	MT264 383 682	COVER	1	Includes items 8, 16, 34 & 35
34	MT3128 3151 418	RELIEF VALVE - GREASE	0	40 BAR
35	MT865 683 09	SOCKET PLUG	0	1/8 BSP
36	MT010 146 631	MIT JACKING BOLT REMOVAL KIT	1	Includes item 29, M20x55 & M30x100 bolts
37	MT323 057 5T	HORIZONTAL SHAFT INSTALL TOOL	1	Included with DPU complete
38	MT264 398 0880	CROSS PIECE BUSH TOOL	0	
39	MT264 333 1800	HORIZONTAL PIVOT BUSH TOOL	0	

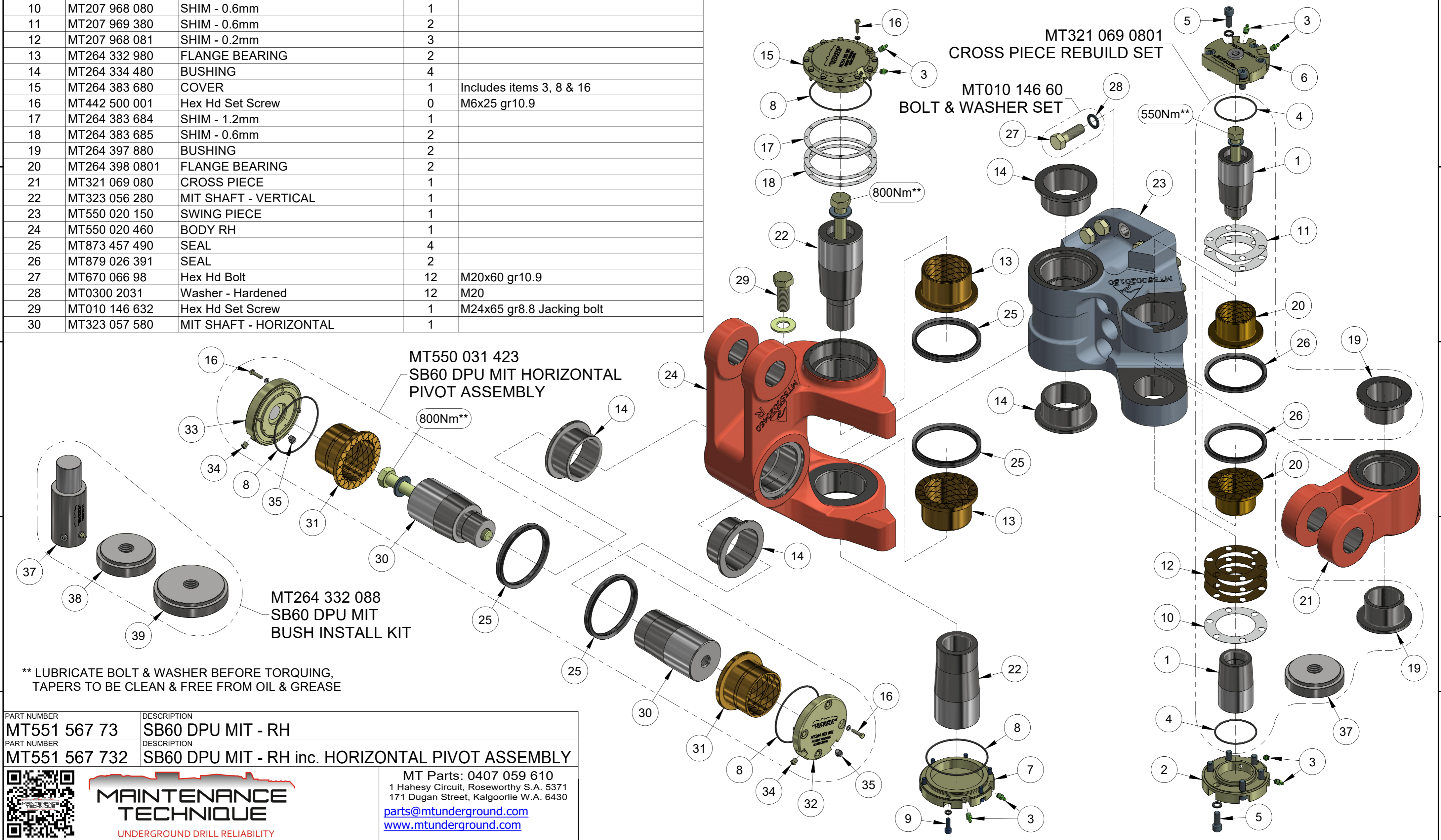

** LUBRICATE BOLT & WASHER BEFORE TORQUING, TAPERS TO BE CLEAN & FREE FROM OIL & GREASE

PART NUMBER MT551 567 73	DESCRIPTION SB60 DPU MIT - RH
PART NUMBER MT551 567 732	DESCRIPTION SB60 DPU MIT - RH inc. HORIZONTAL PIVOT ASSEMBLY

**MAINTENANCE
TECHNIQUE**

UNDERGROUND DRILL RELIABILITY

MT Parts: 0407 059 610
1 Hahesy Circuit, Roseworthy S.A. 5371
171 Dugan Street, Kalgoorlie W.A. 6430
parts@mtunderground.com
www.mtunderground.com