

**STEP 1**

REMOVE PLUG FROM HORIZONTAL JACKING CAP THEN REMOVE BOTH CAPS AND M24x280 BOLT

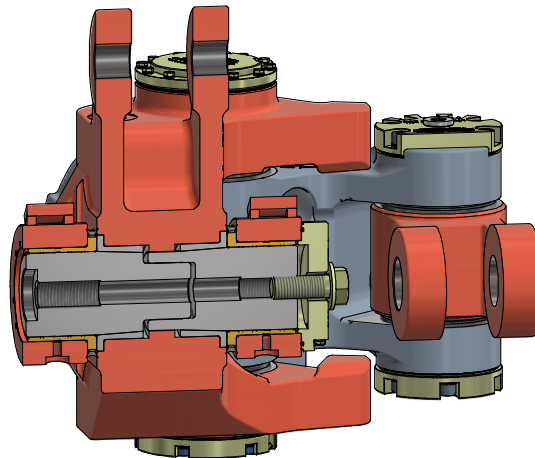

**STEP 2**

FIT HORIZONTAL JACKING CAP TO FEMALE PIN SIDE USING SUPPLIED M24x65 JACKING BOLT AND TIGHTEN IF PIN DOES NOT RELEASE CONTINUE WITH STEP 3 IF PIN DOES RELEASE CONTINUE WITH STEP 6

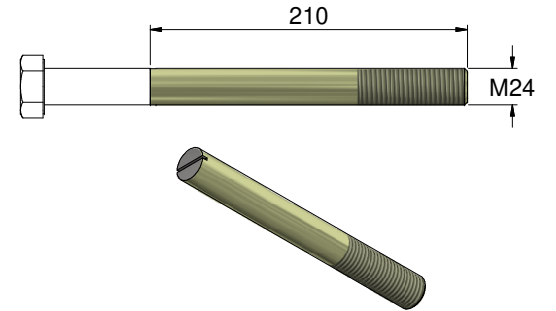

**STEP 3**

CUT M24x280 BOLT TO 210 LONG AND CUT SLOT IN END FOR SCREWDRIVER

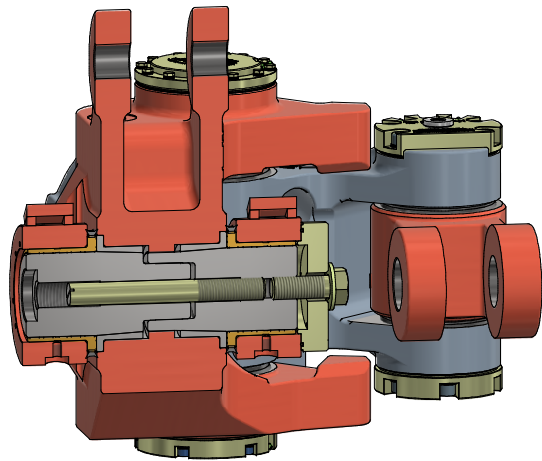

**STEP 4**

SCREW IN CUT OFF M24 BOLT UNTIL IT BOTTOMS OUT THEN UNSCREW 2 1/2 TURNS

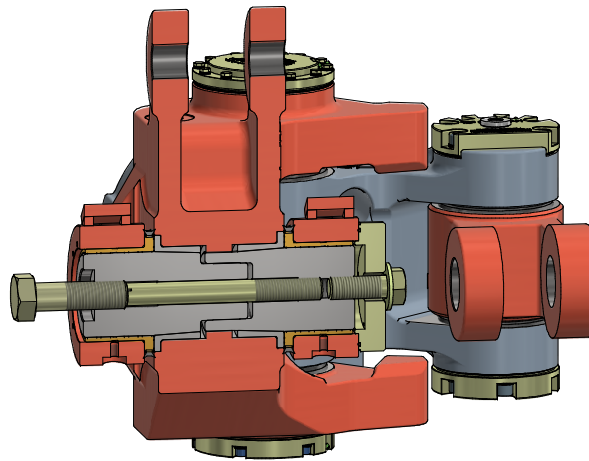

**STEP 5**

SCREW IN SUPPLIED M30x100 JACKING BOLT UNTIL PIN RELEASES

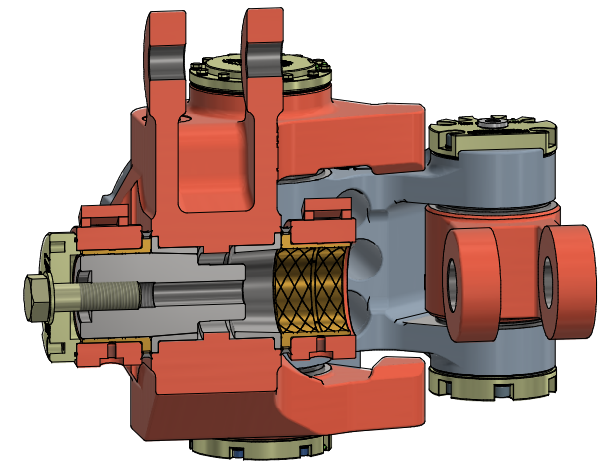

**STEP 6**

FIT HORIZONTAL JACKING CAP TO MALE PIN SIDE USING SUPPLIED M30x100 JACKING BOLT AND TIGHTEN IF PIN FAILS TO RELEASE USE A SUITABLE DRIFT AND HAMMER TO HELP FREE PIN

**NOTE:** GREASE / ANTISEIZE ALL THREADS AND ENDS OF BOLTS

**SB60 MIT DPU HORIZONTAL PIN REMOVAL**



MT Parts: 0407 059 610  
 1 Haesy Circuit, Roseworthy S.A. 5371  
 171 Dugan Street, Kalgoorlie W.A. 6430  
[parts@mtunderground.com](mailto:parts@mtunderground.com) PAGE  
[www.mtunderground.com](http://www.mtunderground.com)