

ITEM	PART NUMBER	DESCRIPTION	QTY	COMMENTS
1	MT060 011 00	REMOTE GREASE PLATE SB	1	incl. O-RINGS
2	MT060 011 001	O-RING	0	
3	MT060 011 002	MANIFOLD	1	2 PORT
4	MT3128 2538 871	MOUNTING PLATE	1	
5	MT3128 2538 87	GREASE DISTRIBUT. BLOCK	1	10 PORT
6	MT0580 0002 00	COUPLING STRAIGHT	8	
7	MT3128 2538 09	HOSE ADAPTOR STRAIGHT	6	
8	MT3128 2538 08	THREADED SLEEVE	16	
9	MT3128 2538 10	HIGH POWER PIPE	1	10m
10	MT0580 2202 00	PIPE COUPLING 90°	4	
11	MT31287 2538 91	HOSE ADAPTOR 90° SHORT	10	
12	MT3128 2539 95	CHECK VALVE - GREASE	6	
13	MT0544 2162 00	GREASE NIPPLE	1	
14	MT3128 3005 37	PLUG	4	

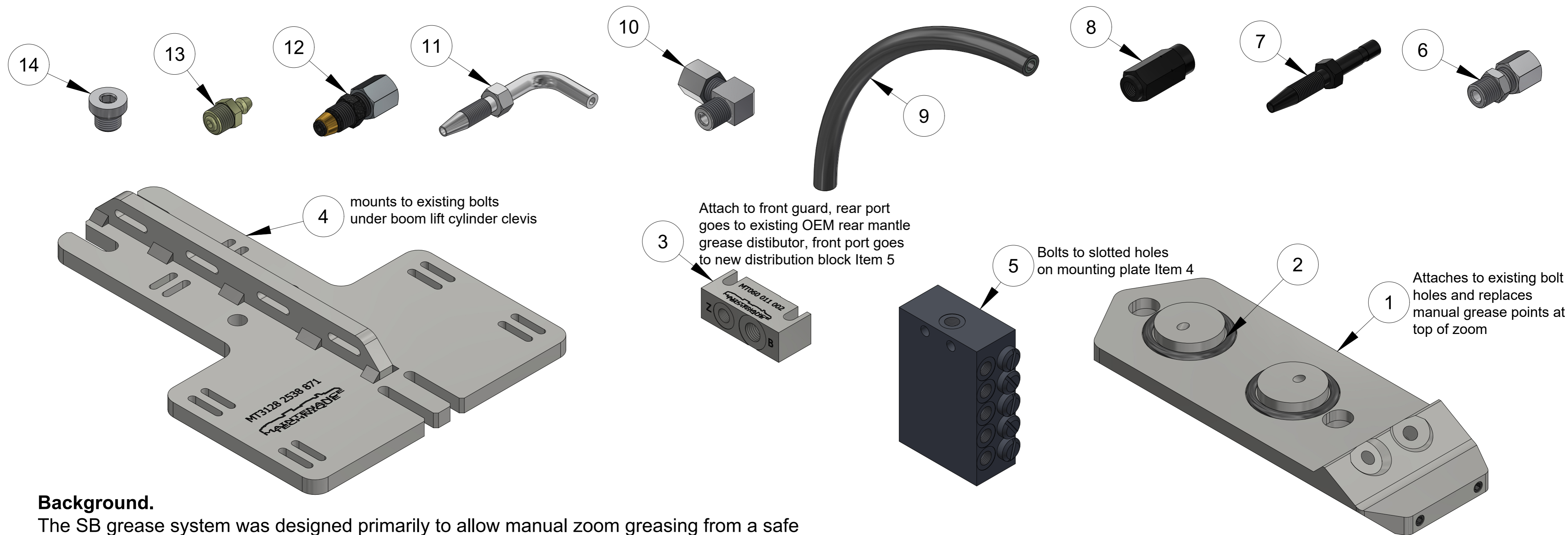

Background.

The SB grease system was designed primarily to allow manual zoom greasing from a safe position at each side wheel arch.

It is also effective when correctly connected to an auto grease system.

Additionally, the schematic prioritizes grease to the top surfaces where most load and wear are present.

Grease to lift cylinders is optional although testing proved them ineffective due to constant damage to fittings and hoses by the feed.

Note - only one port is applied to the lower zoom plate as both nipples grease to the same plate groove is greased with the other receiving a manual nipple.

PART NUMBER	DESCRIPTION
MT060 011 008	SB60 OUTER TUBE REMOTE GREASE SYSTEM
<small>UNDERGROUND DRILL RELIABILITY</small>	
MT Parts: 0407 059 610 1 Haesy Circuit, Roseworthy S.A. 5371 171 Dugan Street, Kalgoorlie W.A. 6430 parts@mtunderground.com www.mtunderground.com	